

A Break-through in Performance and Efficiency

Infrared Luminous Heater

supraSchwank



Now also with
modulating operation



Schwank
INNOVATIVE HEATING SOLUTIONS



Infrared Luminous Heater- supraSchwank

- High radiant factor of 80.9%* and therefore extraordinarily high efficiency
- Available as single stage, 2-stage or fully modulating versions
- With PromaGlafl® insulation / minimisation of the convection losses
- Patented Delta Mixing Chamber
- Combined high- and low-intensity infrared radiation for a high radiant factor
- High-temperature stainless steel refractory mesh
- Schwank ceramic "honeycomb effect" tiles [ceraSchwank]
- Even and comfortable heat distribution
- Short warm-up times
- Quality, long-life cycle and high comfort
- No dust swirls or draughts with supraSchwank luminous heater
- Quick and easy assembly
- Quality "Made in Germany"

* Radiant factor of supraSchwank 30 measured by DVGW laboratory according to DIN EN 419-2

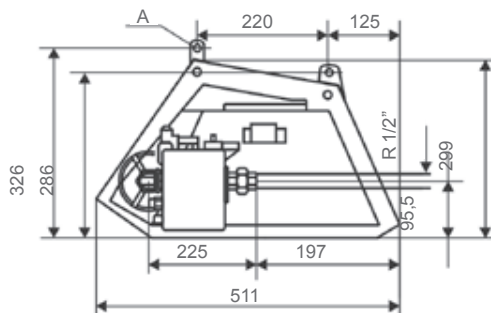
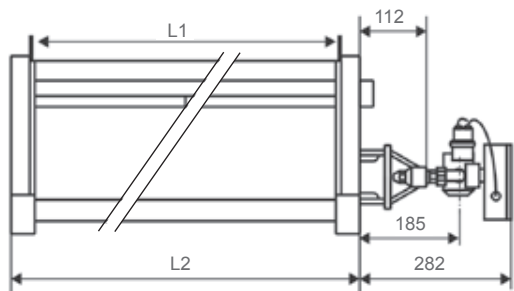

		supraSchwank 10	supraSchwank 15	supraSchwank 20	supraSchwank 30	supraSchwank 40
Gas input * [kW]	Nat. gas H / L	7.7	11.5	15.4	23.1	30.8
	Propane	7.7	11.5	15.4	23.1	30.8
Gas consumption in m³/h **	Nat. gas H / L	0.77 / 0.90 m ³ /h	1.15 / 1.34 m ³ /h	1.54 / 1.80 m ³ /h	2.32 / 2.70 m ³ /h	3.08 / 3.59 m ³ /h
	Propane	0.60 kg/h	0.90 kg/h	1.20 kg/h	1.80 kg/h	2.40 kg/h
Weight [kg]	Appliance	17.0	22.4	29.0	38.0	51.0
	Control	1.4	1.4	1.4	1.4	2.3
Dimensions [mm]	Length L2	629	906	1184	1738	2293
	Length L1	553	830	1108	1662	2217
CE-Identification	CE-0085AU0376					

* The nominal heat load is the heat quantity supplied by the gas based on its thermal value H_n

**Gas consumption: Nat. gas H: H_n = 9.97 kWh/m³ Nat. gas L: H_n = 8.57 kWh/m³ Propane: H_n = 12.87 kWh/kg (at 0°C / 1013 mbar)

Applications

High efficiency heater for industrial applications, warehouses or outdoor heating.

Min. connection pressure

	1-stage	2-stage	modulating
Nat.gas H:	16 mbar	30 mbar	45 mbar
Nat.gas L:	22 mbar	24 mbar	45 mbar
Propane:	32 mbar	65 mbar	65 mbar
Butane:	50 mbar	65 mbar	65 mbar

Max. connection pressure

Nat. gas/ Propane: 100 mbar

Electrical supply

Single-phase AC
 · 230 V, N, PE
 · 50 Hz [approx. 45 VA]

Exhaust flue indirect

according to DIN EN
 13410 or DVGW G 638-1
 or ÖVGW G 3/3

Gas connection

Threaded fitting R 1/2" [male]

Fixture

The heater to be mounted on 4 points [A] with steel cables or the like on the ceiling or wall brackets attached to the wall.

United Kingdom

Schwank Ltd
 Suite 21, 50 Churchill
 Square Business Centre,
 Kings Hill, West Malling,
 Kent ME19 4YU
 Tel.: +44 (0) 208 641 3900
 Fax: +44 (0) 208 641 2594
 E-mail: sales@schwank.co.uk
 Internet: www.schwank.co.uk

Ireland

Hevac
 Muirfield Drive
 Naas Road, Dublin 12
 Ireland
 Tel.: +353 1 419 1919
 Fax: +353 1 458 4806
 E-mail: info@hevac.ie
 Internet: www.hevac.ie

Australia

Devex Systems Pty Limited
 5/83 Bassett St
 Mona Vale NSW 2103
 Tel.: +61 02 9997 2811
 Fax: +61 02 9997 7852
 E-mail: info@devexsystems.com.au
 Internet: www.devexsystems.com.au

New Zealand

Energy Products Int.
 30 Gallagher Drive,
 Frankton, Hamilton
 Tel.: +64 7 839 2705
 Fax: +64 7 834 4212
 E-mail: sales@energy-products.co.nz
 Internet: www.energy-products.co.nz

